

A

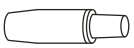

1PC

1

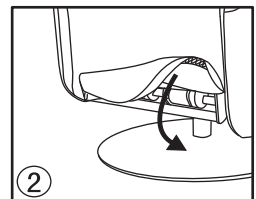
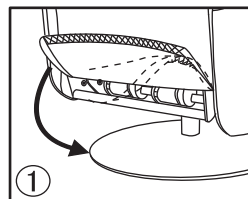
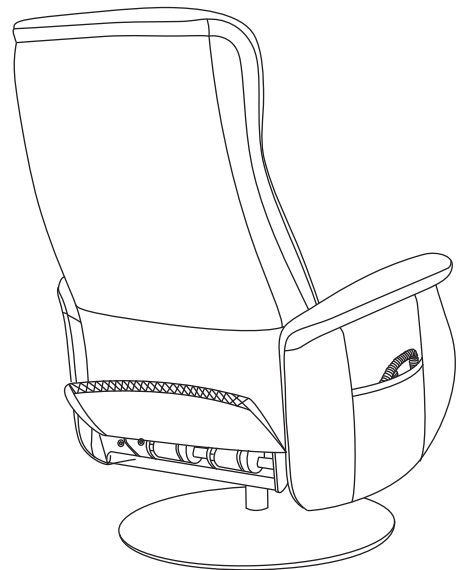
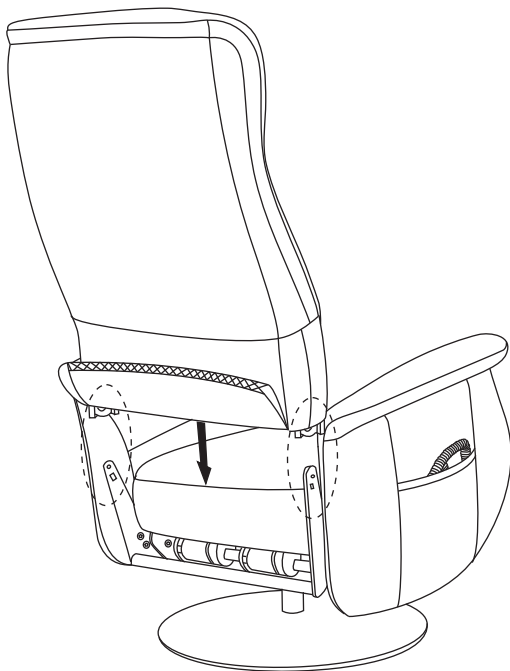

2

1

2

3

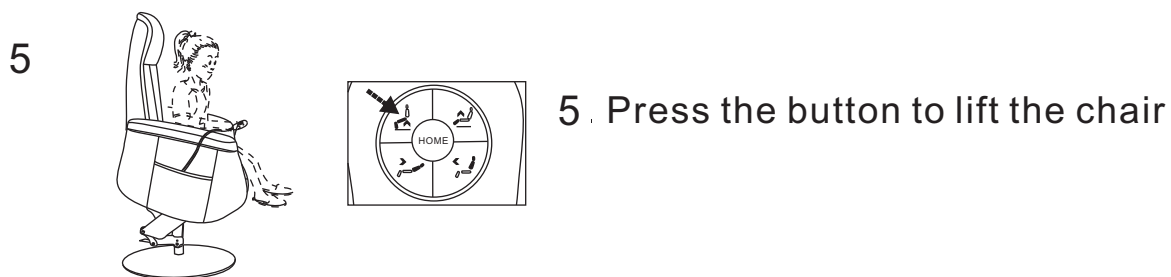
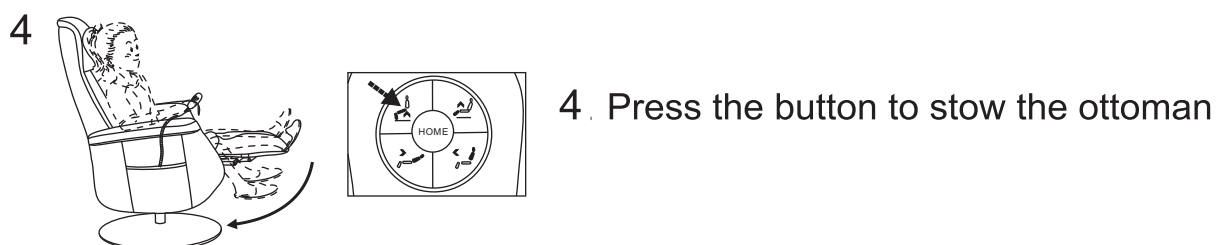
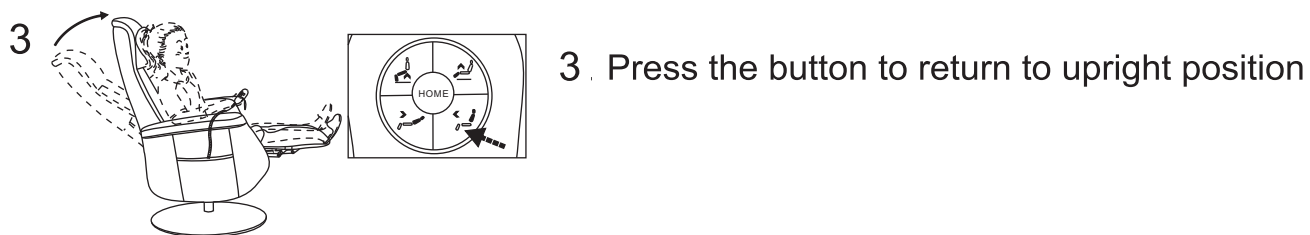
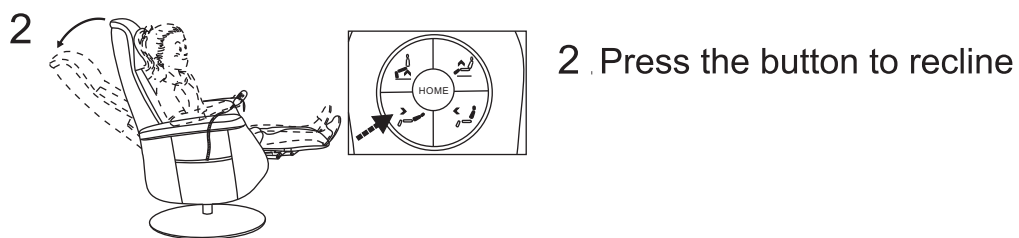
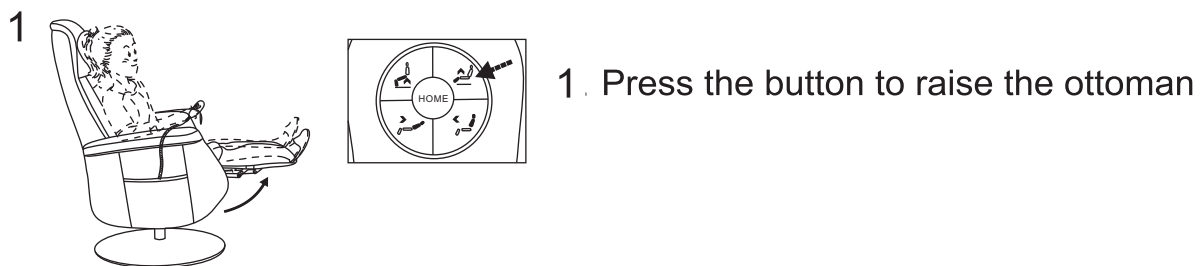

# How to adjust the headrest



To adjust the headrest, grip the backside of the headrest and pull forward from both sides as shown



**DO NOT** pull from the side edges, as the material may tear



To adjust the headrest backward, push on both sides or use a forearm to evenly move the headrest

**Caution:**  
Do not push in the center of the headrest, as this may cause the cushion to collapse

